

SECTION

MINIMUM BEARING AREA

PIPE DIA	AREA SQ. FT.
4"	5
6"	5
8"	8
10"	13
12"	18

NUMBER OF TIE RODS REQUIRED

PIPE DIA	3/4" RODS
4"	2
6"	2
8"	2
10"	4
12"	4

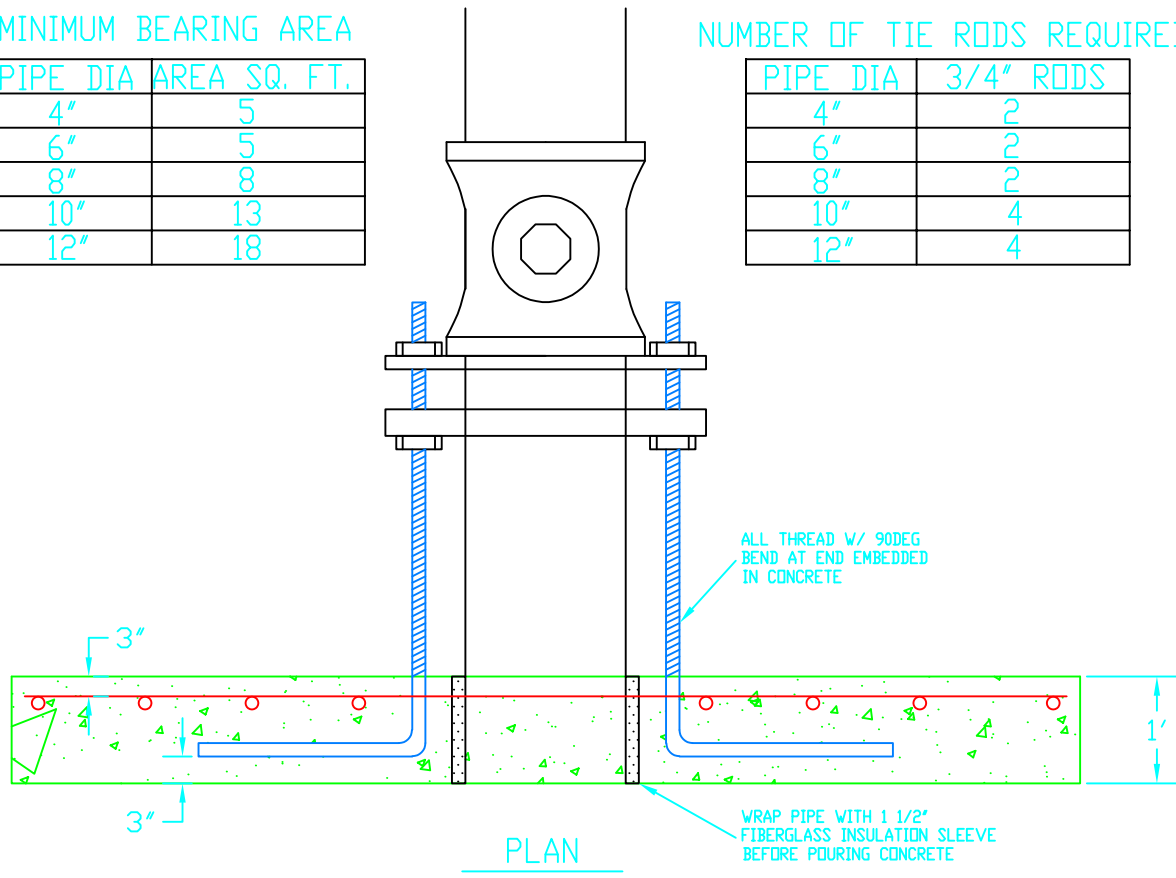

REV	DATE
0	4/18/17
DRAWN BY: AS	
CHECKED BY: TG	

Construction Standard Thrust Collar

Energy Management
Campus Facilities
UNIVERSITY OF MISSOURI



DRAWING NOT TO SCALE
DATE: 4/18/17